



UPTREE CONSULTANCY SERVICES PRIVATE LIMITED

UPTREE INTERACTIVE FLAT PANEL



Get in touch with us:

 **+91 99586 00419**

 **+91 79493 98749**

 **info@uptree.in**

 **www.uptree.in**

Follow Us On!

    
@uptreeofficial

Uptree Interactive Flat Panel



The Uptree Interactive Flat Panel is a high-performance display solution designed for smart classrooms and professional environments. It features a 4K UHD screen with ultra-responsive multi-touch technology for smooth writing, annotation, and seamless collaboration. Built with durable toughened glass and a sleek metallic finish, it offers both reliability and a premium design. With front-facing speakers, multiple connectivity options, and wireless support, Uptree IFP ensures engaging and efficient presentations and learning experiences.

Now available with Android 13, 14, and 16 for faster performance, better security, and an enhanced smart panel experience.

KEY BENEFITS OF UPTREE IFP

- 1. Smooth & Natural Writing:** Experience ultra-responsive, lag-free touch performance that delivers a precise and comfortable pen-on-paper feel.
- 2. Reliable & Low Maintenance:** Built with high-quality components to ensure consistent performance with minimal upkeep after installation.
- 3. Smart Connectivity:** Equipped with multiple connectivity options for seamless integration with laptops, USB devices, audio systems, and other classroom equipment.
- 4. High-Value Pricing:** Advanced features at competitive pricing, offering excellent returns and strong profit potential.



Uptree Interactive Flat Panel



Advanced features for enhanced performance:

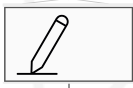

Lag-Free Writing Experience



3 Years Panel Software Warranty



Secure Collaboration Tools



Multi-Touch Support



4K Ultra HD Display



Whiteboard & Annotation



50,000 hours Screen life warranty



Smart Multiple Cable Connectivity



Cross-Platform Compatibility



Dual OS Support Android/Windows



Smart Internet Access



Wireless Screen Sharing



Multi-Language Support



3D Models and Images



Never-Ending Pages

MODERN SLIM DESIGN



OPS Slot

Built-in OPS slot for easy PC integration, enabling a clean, all-in-one setup without external CPU devices.

MULTIPLE BACKSIDE I/O PORTS

Multiple I/O ports for easy connectivity with USB, HDMI, audio devices, and other external equipment.

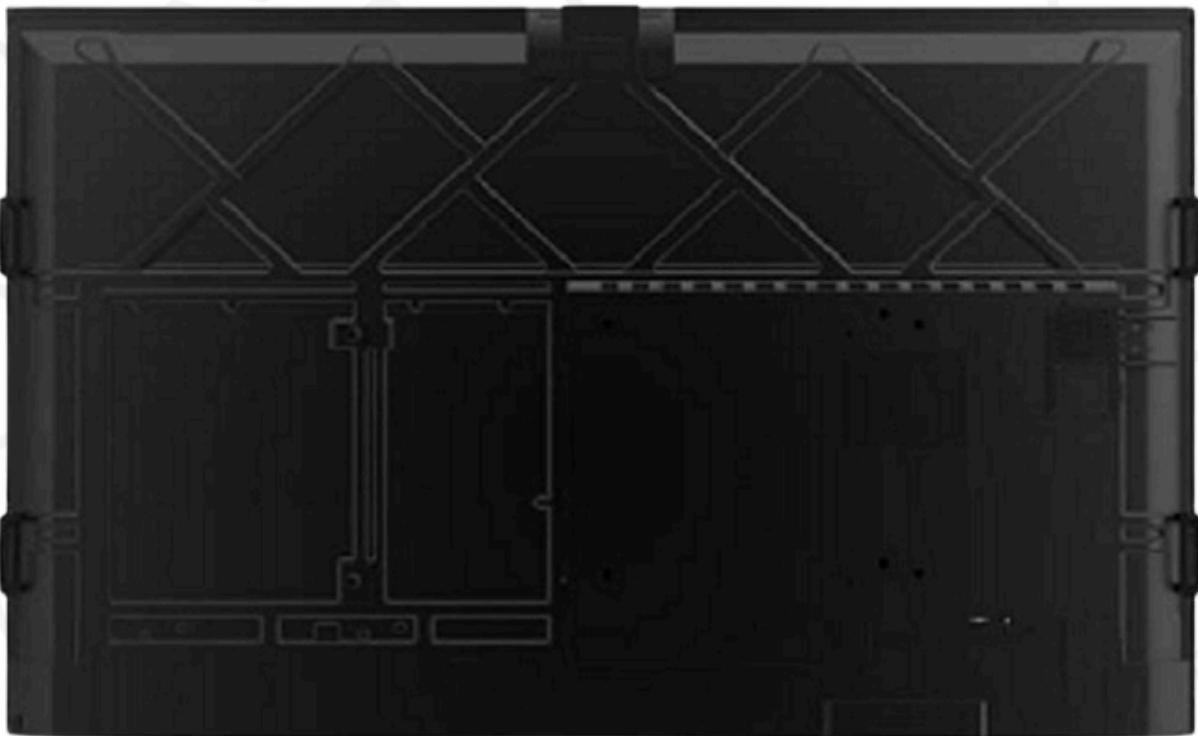

Panel Rear View



ADVANCED SERIES



Experience seamless performance with a sleek, space-saving design built for modern workspaces and learning environments. Enjoy ultra-smooth touch response, vibrant visuals, and powerful processing that make presentations, teaching, and collaboration effortless and engaging.

PRICING:

65" Android 14 | 8GB RAM | 128GB SSD

MRP: ₹99,999/- Offer Price: ₹72,999 + 18% GST

75" Android 14 | 8GB RAM | 128GB SSD

MRP: ₹1,19,999/- Offer Price: ₹84,999 + 18% GST

86" Android 14 | 8GB RAM | 128GB SSD

MRP: ₹1,49,999/- Offer Price: ₹1,15,999 + 18% GST

98" Android 14 | 8GB RAM | 128GB SSD

MRP: ₹3,29,999/- Offer Price: ₹2,29,999 + 18% GST



PRO SERIES



Empower your classroom or workspace with [official Google EDLA certification](#), ensuring [advanced security, regular updates, and full access to Google apps](#) and services. Enjoy smooth integration, enhanced data protection, and a reliable Android experience designed for smarter collaboration and productivity.

PRICING:

65" EDLA Certified Android 14 | 8GB RAM | 128GB SSD

~~MRP: ₹1,09,999/-~~ Offer Price: ₹79,999 + 18% GST

65" EDLA Certified Android 16 with AI | 8GB RAM (DDR 5) | 128GB SSD

~~MRP: ₹1,19,999/-~~ Offer Price: ₹89,999 + 18% GST

75" EDLA Certified Android 14 | 8GB RAM | 128GB SSD

~~MRP: ₹1,29,999/-~~ Offer Price: ₹94,999 + 18% GST

75" EDLA Certified Android 16 with AI | 8GB RAM (DDR 5) | 128GB SSD

~~MRP: ₹1,44,999/-~~ Offer Price: ₹1,05,999 + 18% GST

86" EDLA Certified Android 14 | 8GB RAM | 128GB SSD

~~MRP: ₹1,59,999/-~~ Offer Price: ₹1,19,999 + 18% GST

86" EDLA Certified Android 16 with AI | 8GB RAM (DDR 5) | 128GB SSD

~~MRP: ₹1,69,999/-~~ Offer Price: ₹1,31,999 + 18% GST

98" EDLA Certified Android 14 | 8GB RAM | 128GB SSD

~~MRP: ₹3,39,999/-~~ Offer Price: ₹2,39,999 + 18% GST



PREMIUM SERIES



All-in-one collaboration made simple. With an **integrated high-quality camera and crystal-clear microphone**, this interactive flat panel ensures seamless video conferencing, online teaching, and hybrid meetings, delivering clear visuals, superior audio, and a clutter-free setup for a smarter, more connected experience.

PRICING:

65" Camera & Mic Android 14 | 8GB RAM | 128GB SSD

MRP: ₹1,14,999/- Offer Price: ₹85,999 + 18% GST

65" Camera & Mic EDLA Certified Android 16 | 8GB RAM | 128GB SSD

MRP: ₹1,28,999/- Offer Price: ₹94,999 + 18% GST

75" Camera & Mic Android 14 | 8GB RAM | 128GB SSD

MRP: ₹1,34,999/- Offer Price: ₹1,01,999 + 18% GST

75" Camera & Mic EDLA Certified Android 16 | 8GB RAM | 128GB SSD

MRP: ₹1,54,999/- Offer Price: ₹1,11,999 + 18% GST

86" Camera & Mic Android 14 | 8GB RAM | 128GB SSD

MRP: ₹1,64,999/- Offer Price: ₹1,25,999 + 18% GST

86" Camera & Mic EDLA Certified Android 16 | 8GB RAM | 128GB SSD

MRP: ₹1,79,999/- Offer Price: ₹1,38,999 + 18% GST

98" Camera & Mic Android 14 | 8GB RAM | 128GB SSD

MRP: ₹3,44,999/- Offer Price: ₹2,45,999 + 18% GST



Accessories



IFP Panel Mount kit

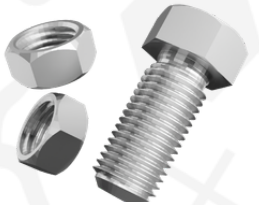

Mount Kit Nut



Remote



Power Cable



Stylus Pen



HDMI Cable



Touch Cable



Wi-Fi Antenna

Available In Different Sizes

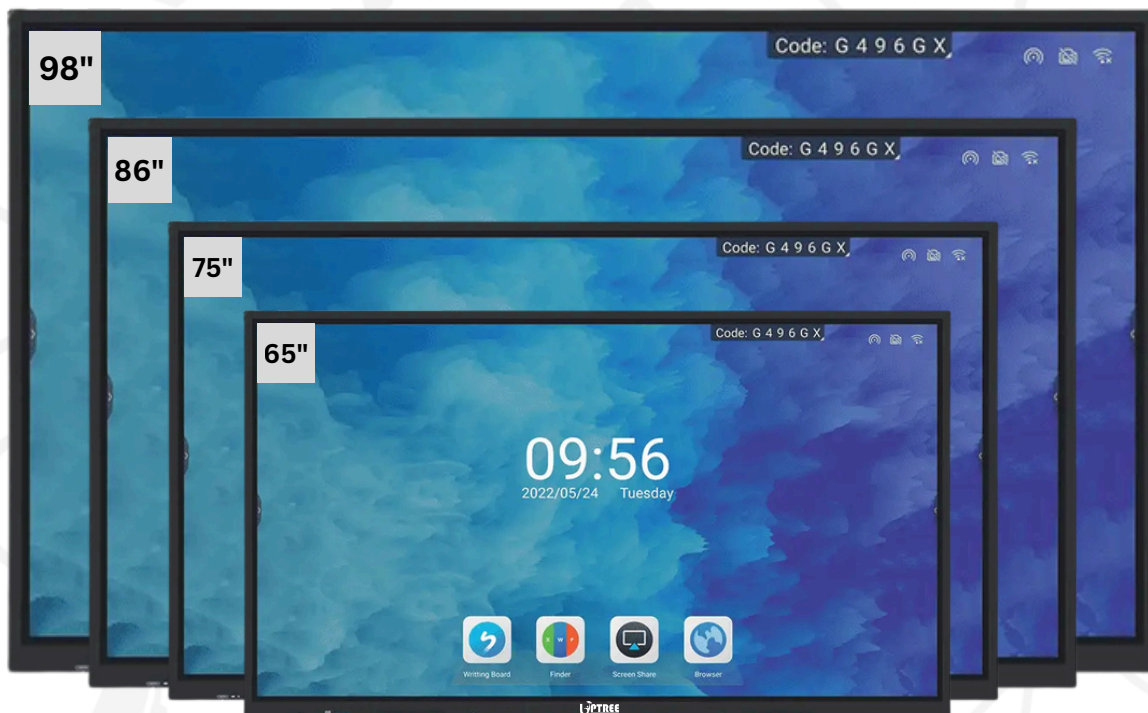

SPECIFICATIONS

Display Parameter						
Resolution	3840*2160/UHD	✓	✓	✓	✓	✓
Aspect Ratio	16:09	✓	✓	✓	✓	✓
Contrast Ratio	1200:1/4000:1	✓	✓	✓	✓	✓
Colors	1.07 billion colors	✓	✓	✓	✓	✓
Brightness	450 cd/m2	350 cd/m2	✓	✓	✓	✓
Viewing Angle	178°	✓	✓	✓	✓	✓
Screen Surface	4 mm thickness Anti-Glare glass	✓	✓	✓	✓	✓
Panel Interactivity						
Touch Technology	IR Touch	✓	✓	✓	✓	✓
Touch Points	40 point (Win 7/8/10) 20 points touch (Android)	✓	✓	✓	✓	✓
Touch Accuracy	± 2mm (Windows)	± 1mm	✓	✓	✓	✓
Recognition	Finger or passive stylus	✓	✓	✓	✓	✓
Response Rate	<4 ms (single touch) <10 ms (max touch inputs)	✓	✓	✓	✓	✓
Minium Object Size	2mm	✓	✓	✓	✓	✓
Response Time	<5ms	<8ms	✓	✓	✓	✓
Hotspot	Yes	✓	✓	✓	✓	✓
Bluetooth	V 5.0	✓	✓	✓	✓	✓
WiFi	Version 802.11 ac/b/g/n/a/ax & working frequency 2.4 GHz/5 GHz	✓	✓	✓	✓	✓
Back Side Connectivity						
Front Ports	USB 3.0 * 3 (Pubic) Touch out USB type A * 1 HDMI IN 2.0 * 1 Type C * 1	✓	✓	✓	✓	✓
Front Button	Indicator: Red/Blue; Buttons: Screen Record; Image Aspect Ratio; V-; V+ ; Setting; Eye Protect: Power	✓	✓	✓	✓	✓
Speaker		15W*2	15W*2	15W*2	20W*2	20W*2
Operating System						
Android Version	Android 11.0 / 12.0 / 13.0 / 14.0	✓	✓	✓	✓	✓
Chipset	V100 / Amlogic T982	✓	✓	✓	✓	✓
CPU	Quad Core / Octa Core	✓	✓	✓	✓	✓
GPU	Mali - G52MP2	✓	✓	✓	✓	✓
RAM	4GB (8GB Optional) System Memory	✓	✓	✓	✓	✓
ROM	32GB (128GB Optional) System Storage	✓	✓	✓	✓	✓
Compliant With	Windows, Mac, Linux, Chrome OS	✓	✓	✓	✓	✓
Gross Weight	(Kg ± 2)	52	56	68	98	115.3
Bare Dimension (mm)*	(L*H*W)	1270 * 774.7 * 23	1483.4 * 896.6 * 87.2	1709 * 1020 * 88	1957 * 1160 * 100	2215.8 * 1322.7 * 126
Packing Dimension (mm)*	(L*H*W)	1371.6 * 889 * 177.8	1630 * 1050 * 220	1860 * 1160 * 220	2120 * 1325 * 220	2357 * 1478 * 215
Input Voltage	100-240V (50/60hz 4A)	✓	✓	✓	✓	✓
Power Consumption		Max 280W	Max 280W	Max 350W	Max 450W	Max 650W
Camera & Mic	48 Megapixel Camera and 8 Array Mic (Optional)		✓	✓	✓	✓

*Terms And Conditions Applied.



Our Happy Clients

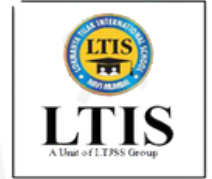

गृह मंत्रालय
MINISTRY OF
HOME AFFAIRS



Redcliffe
labs



Trusted and Verified Seller on



GeM
Government
e Marketplace



indiamart®

Justdial

Uptree Consultancy Services Pvt. Ltd.

Office Address : B-607 Shalin Square Lal Gebi Circle, S.P.Ring

Road, Vinzol, Hathijan, Ahemdabad, Gujarat 382445

Email id : info@uptree.in | Website : www.uptree.in

Phone No. : +91-9958600419, +91-8511436969, +91-8511456969

Landline Number : 07949398749

